

Exchangeable fuse system

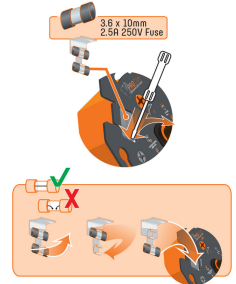

0190062 Universal Dimmer - PD450 - Auto leading/trailing edge - 2-way

- Automatic detection of load type and switch to either leading or trailing edge mode
- Overheating and overload protection
- Automatic waveform correction and soft start



Easily control the brightness of your lights and create the perfect light for every occasion with the high-power universal dimmer.

The dimmer automatically detects the load type and switches to either leading or trailing edge mode. In addition, the waveform is automatically corrected to prevent voltage and current pulses. The minimum brightness is adjustable as well.

In addition, the dimmer is protected against overheating and overload and includes a soft start which automatically lowers the inrush current.

The dimmer dims noise-free and the lights will not flicker when there is switched on and off or toggled between different power sources. Besides that, the dimmer has a wide input frequency range and is compatible with most covers and knobs in Europe with use of complementary accessories.

Lamps can be dimmed from 0-100%. The dimmer has low built-in dimensions and the dimmer includes clamps. It is made of flame retardant material and for installation no neutral wire is necessary.

This product is exclusive for the wholesaling market.

General

| | |
|-----------------|---|
| Brand | ProDim |
| Collection | Functional |
| Manual language | Dutch, English, French, German, Spanish |
| Package content | Wall plate adapters |
| PLC Status | Phase out |
| Warranty | 5-Year |

[Smart] Dimming and Switching

| | |
|---|--------------------------------|
| Compatible with | 2-wire systems, 3-wire systems |
| Min. depth of built-in installation box | 30 mm |
| Fits to European Flush boxes | Yes |
| Memory function (color/dim) | Yes |
| Neutral required | No |

Electrical

| | |
|----------------|----------------------------------|
| Load type | Capacitive, Inductive, Resistive |
| Input voltage. | 220 — 240 V |

| | |
|-----------------|-----------------------------|
| Voltage type | AC |
| Input frequency | 50/60 Hz |
| Power factor | 0.95 |
| Input current. | 2300 — 2300 null |
| Safety class | II |
| Type of dimming | Leading-edge, Trailing-edge |

Performance

| | |
|------------------------|-------------|
| IP Rating | IP20 |
| Operating Temperature | -10 — 40 °C |
| Max. load LED (VA) | 500 VA |
| Max Load LED (@PF 0.5) | 250 W |
| Max Load LED (@PF 0.9) | 450 W |
| Max. load INC/HAL (W) | 500 W |

Mechanical

| | |
|-------------------------|---------------------|
| Conductor cross section | 2.5 mm ² |
| Article length | 70 mm |
| Article width | 37 mm |
| Article height | 70 mm |
| Article net weight | 85 g |
| Built-in length | 51 mm |
| Built-in width | 51 mm |
| Built-in height/depth | 24 mm |
| Housing material | Aluminum, Plastic |
| Color housing | Grey, Orange |
| Connection type | Screw |

Logistic Data

| | |
|-----------------------------------|---------------|
| Packaging length | 8.5 cm |
| Packaging width | 6 cm |
| Packaging height | 8.7 cm |
| Packaging gross weight | 114 g |
| EAN Product | 8720246202861 |
| Packaging paper material weight | 26 g |
| Packaging plastic material weight | 3 g |
| Master carton length | 36 cm |

| | |
|---------------------------------------|-----------------------|
| Master carton width | 35 cm |
| Master carton height | 30 cm |
| CBM master carton | 0.0378 m ³ |
| Master carton quantity | 60 |
| Master carton gross weight | 7.7 kg |
| Master carton paper material weight | 2444 g |
| Master carton plastic material weight | 156 g |
| Country of Origin | CN |
| HS Code | 8536508090 |

View on the website: www.shada.nl/p/0190062